

PASSCODE LOCK

Instruction



How to change passcode

1. Default password is 0 0 0
2. Look at the back of passcode
3. Push slug as shown in picture 2
4. Set up 3 digits new password
5. Push slug as shown in picture 4

No. 1



No. 2

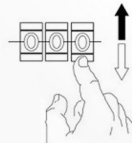

No. 3



No. 4

How to find passcode

1. Push master key as shown in picture 1
2. Turn passcode until it stop. The number that passcode stop is your passcode
3. Repeat all steps for next digit

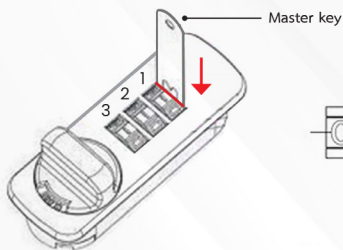

No. 1

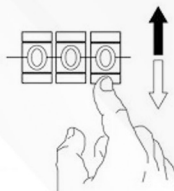

No. 2

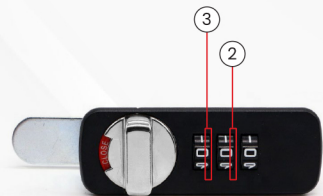

No. 3